

**"WORKS AS CONSTRUCTED"**  
 It is certified that the original drawing has been carefully compared with the work As Constructed, as to line, level and dimensions and it has been accurately amended so as to constitute a true and correct record of the work As Constructed.

CARDNO (QLD) PTY LTD  
 WORK AS EXECUTED

SUPERVISED: \_\_\_\_\_ DRAWN: \_\_\_\_\_ CHECKED: \_\_\_\_\_  
 PASSED: \_\_\_\_\_  
 DATE: 06/10/09 RPE: 7109

15

38006

DRAWING REVISIONS		REFERENCE DRAWINGS		DESIGN FILE No.	M1681	DESIGNED	CARDNO	THIS WORK WAS PREPARED BY:			JOB TITLE		CSC SUBDIVISION REFERENCE	
REV.	REVISION DESCRIPTION	DRG. No.	DESCRIPTION	CONSTRUCT. No.	M1681	DATE	09/02/07	Consulting Engineers			TRINITY WATERS ESTATE BEACHMERE STAGE 2A PEET AND COMPANY LIMITED		IMP-7	
A	ORIGINAL ISSUE TO COUNCIL			SURVEY FILE No.	M1681	DRAWN	PEP	JF&P CONSULTING ENGINEERS PTY. LTD. ABN 77 050 414 030 237-239 Bradman Avenue, Maroochydore, Queensland, 4558 telephone (07) 5433 2600			'AS CONSTRUCTED - ROADS AND LAND'		No. OF PLANS	REV.
				FIELD BOOK		DATE	20/03/09	SCALE 1:500 ORIGINAL SIZE A1					ASCEN GRID NUMBER	
				LOG BOOK		CHECKED	ADF						38006	A
				LEVEL DATUM	AHD RL 2.249	DATE	20/03/09							
				DATUM	PSM 90413									

1 2 3 4 5 6 7 8 9 10 11 12

A  
B  
C  
D  
E  
F  
G  
H

**"WORKS AS CONSTRUCTED"**  
 It is certified that the original drawing has been carefully compared with the work As Constructed, as to line, level and dimensions and it has been accurately amended so as to constitute a true and correct record of the work As Constructed.  
 CARDNO (QLD) PTY LTD  
 WORK AS EXECUTED  
 SUPERVISED: DRAWN: CHECKED:  
 PASSED: DATE: 20/03/09 RPEO: 7109

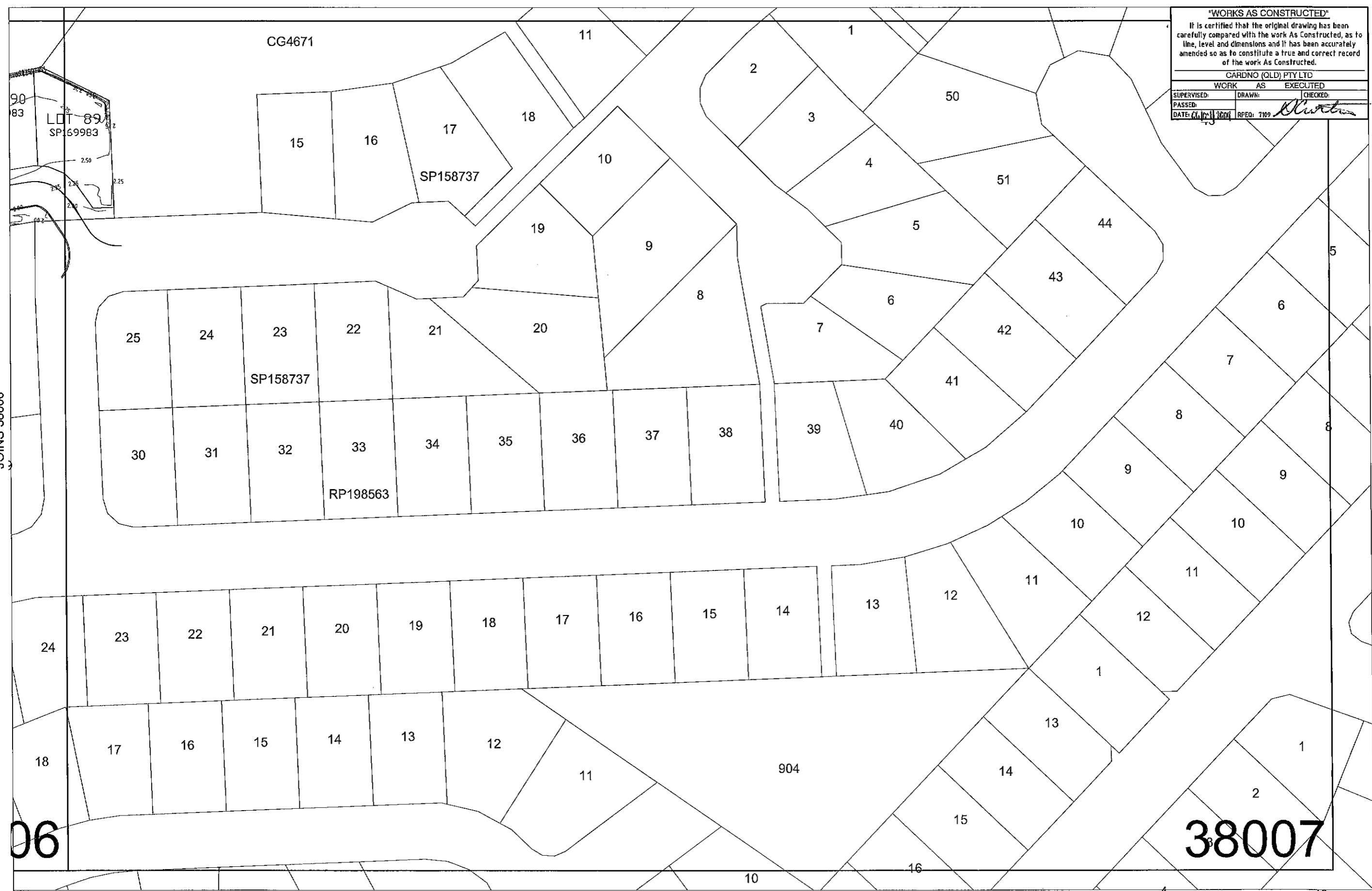

06 38007

DRAWING REVISIONS		REFERENCE DRAWINGS		DESIGN FILE No.	M1681	DESIGNED	CARDNO	THIS WORK WAS PREPARED BY:		<b>MORETON BAY REGIONAL COUNCIL</b> CABOOLTURE DISTRICT OFFICE 2 HASKING STREET CABOOLTURE QLD 4510 PO BOX 159 CABOOLTURE QLD 4510 Telephone: (07) 5433 0100 Fax: (07) 5433 4000	JOB TITLE		CSC SUBDIVISION REFERENCE	
REV.	REVISION DESCRIPTION	DRG. No.	DESCRIPTION	CONSTRUCT. No.	M1681	DATE	09/02/07	<b>Consulting Engineers</b> JF&P CONSULTING ENGINEERS PTY. LTD. ABN 77 050 414 036 257-259 Bradman Avenue Maroochydore, Queensland, 4558 telephone (07) 5443 2600 www.jfp.com.au			TRINITY WATERS ESTATE BEACHMERE STAGE 2A PEET AND COMPANY LIMITED 'AS CONSTRUCTED - ROADS AND LAND'		IMP-7 No. OF PLANS ASCON GRID NUMBER REV.	
A	ORIGINAL ISSUE TO COUNCIL			SURVEY FILE No.	M1681	DRAWN	PEP	SCALE 1:500 ORIGINAL SIZE A1				38006 A		
				FIELD BOOK		DATE	20/03/09							
				LOG BOOK		CHECKED	ADF							
				LEVEL DATUM	AHD RL2.249	DATE	20/03/09							
				DATUM	PSM 90413									

1 2 3 4 5 6 7 8 9 10 11 12

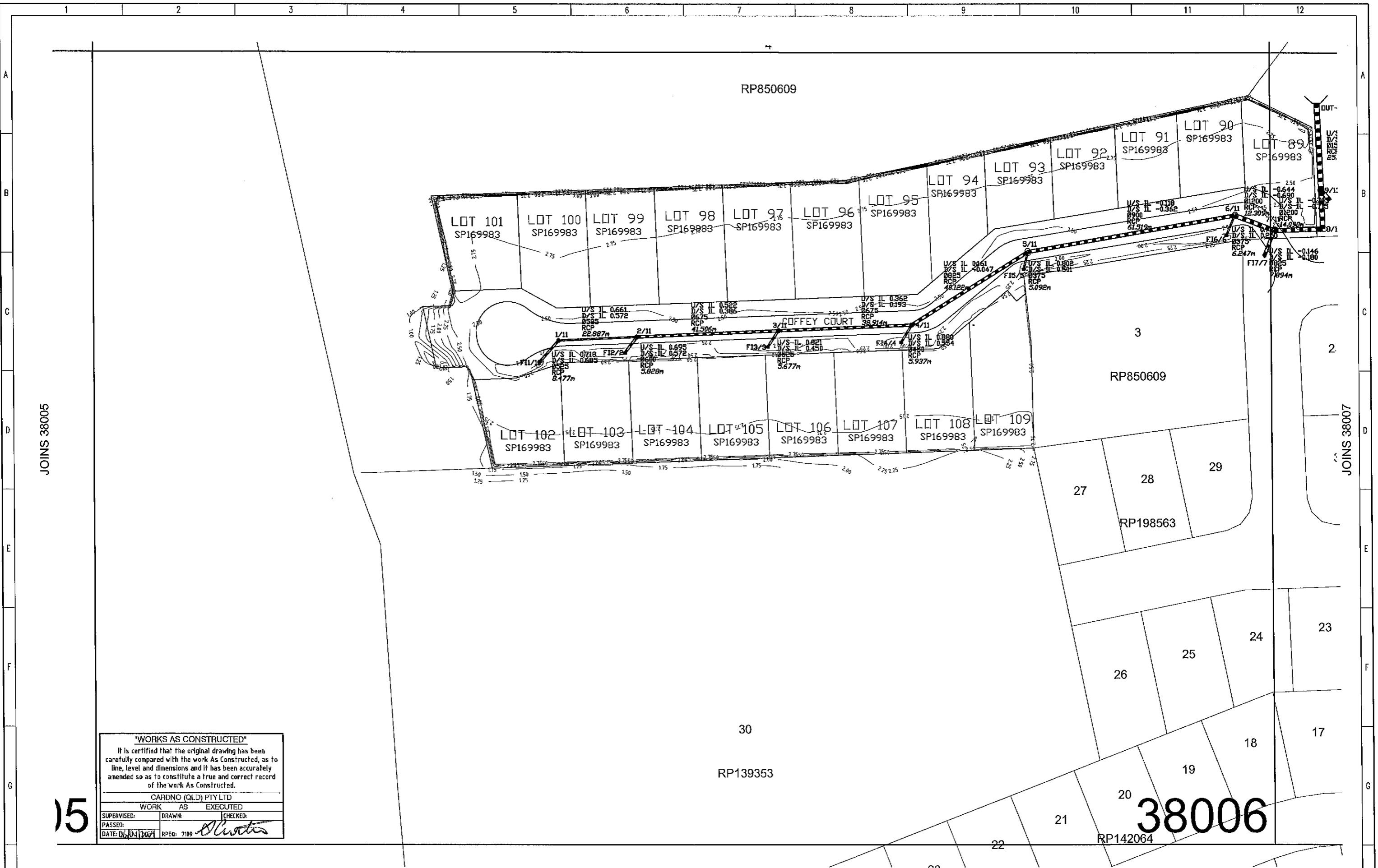

**"WORKS AS CONSTRUCTED"**  
 It is certified that the original drawing has been carefully compared with the work As Constructed, as to line, level and dimensions and it has been accurately amended so as to constitute a true and correct record of the work As Constructed.

CARDNO (QLD) PTY LTD  
 WORK AS EXECUTED  
 SUPERVISED: DRAWN: CHECKED:  
 PASSED:  
 DATE: 11/11/07 RPEQ: 7109

**38006**

DRAWING REVISIONS		REFERENCE DRAWINGS		DESIGN FILE No.	M1681	DESIGNED	CARDNO	THIS WORK WAS PREPARED BY:		MORETON BAY REGIONAL COUNCIL		JOB TITLE		CSC SUBMISSION REFERENCE	
REV.	REVISION DESCRIPTION	DRG. No.	DESCRIPTION	CONSTRUCT. No.	M1681	DATE	09/02/07	Consulting Engineers		CABOOLTURE DISTRICT OFFICE		TRINITY WATERS ESTATE		IMP-7	
A	ORIGINAL ISSUE TO COUNCIL			SURVEY FILE No.	M1681	DRAWN	PEP	JF&P CONSULTING ENGINEERS PTY. LTD. ABN 77 060 414 039		2 HASKING STREET CABOOLTURE QLD 4510		BEACHMERE STAGE 2A		No. OF PLANS	
				FIELD BOOK		DATE	20/03/09	237-239 Bradmen Avenue,		PO BOX 158 CABOOLTURE QLD 4510		PEET AND COMPANY LIMITED		ASCON GRID NUMBER	
				LOG BOOK		CHECKED	ADF	Maroochydore, Queensland, 4558		Telephone: (07) 5438 0100				REV.	
				LEVEL DATUM	AHD RL.2.249	DATE	20/03/09	telephone (07) 5443 2500		Fax: (07) 5438 4000		'AS CONSTRUCTED - DRAINAGE'		38006	
				DATUM	PSM 80413			SCALE 1:500		ORIGINAL SIZE A1				A	

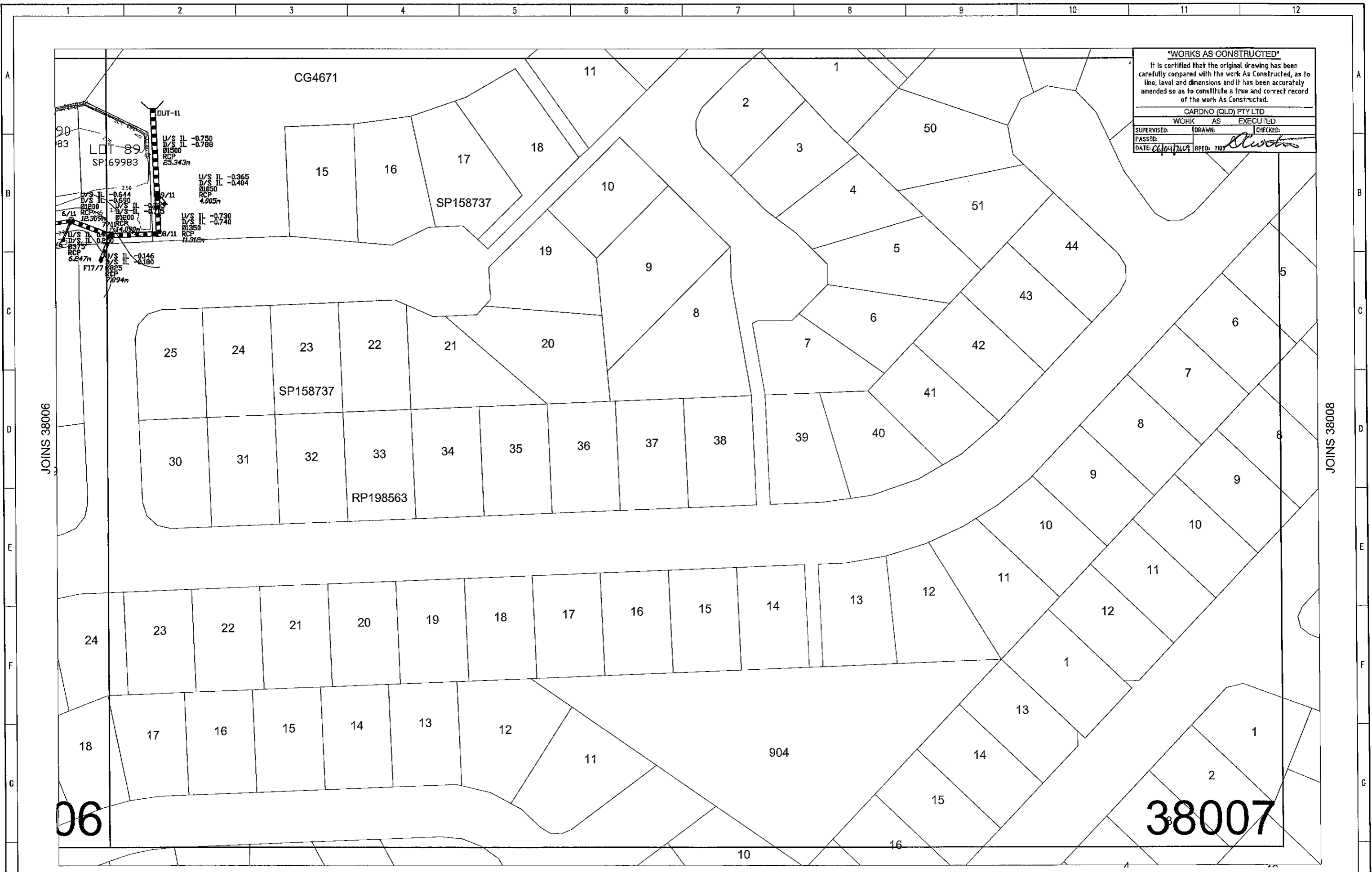

**"WORKS AS CONSTRUCTED"**  
 It is certified that the original drawing has been carefully compared with the work As Constructed, as to line, level and dimensions and it has been accurately amended so as to constitute a true and correct record of the work As Constructed.

CARDNO (QLD) PTY LTD  
 WORK AS EXECUTED  
 SUPERVISED: DRAWN: CHECKED:  
 PASSED: DATE: 26/04/2009 RPE: 7109

JOINS 38006

JOINS 38008

06

38007

DRAWING REVISIONS		REFERENCE DRAWINGS		DESIGN FILE No.	M1681	DESIGNED	CARDNO	THIS WORK WAS PREPARED BY:			MORETON BAY REGIONAL COUNCIL		JOB TITLE		CSC SUBDIVISION REFERENCE	
REV.	REVISION DESCRIPTION	DRG. No.	DESCRIPTION	CONSTRUCT. No.	M1681	DATE	09/02/07	Consulting Engineers			CABOOLTURE DISTRICT OFFICE		TRINITY WATERS ESTATE		IMP-7	
A	ORIGINAL ISSUE TO COUNCIL			SURVEY FILE No.	M1681	DRAWN	PEP	J&P CONSULTING ENGINEERS PTY. LTD. ABN 77 050 414 030			2 HASKING STREET CABOOLTURE QLD 4610		BEACHMERE STAGE 2A		No. OF PLANS	
				FIELD BOOK		DATE	20/03/09	237-239 Bredman Avenue,			PO BOX 160 CABOOLTURE QLD 4610		PEET AND COMPANY LIMITED		ASCEN GRID NUMBER	
				LOG BOOK		CHECKED	ADF	Maroochydore, Queensland, 4550			Telephone: (07) 5433 0100				REV.	
				LEVEL DATUM	AHD RL2.249	DATE	20/03/09	www.jp.com.au			Fax: (07) 5433 4000				38006	
				DATUM	PSM 90413			SCALE 1:500							A	
								ORIGINAL SIZE A1								



**"WORKS AS CONSTRUCTED"**  
 It is certified that the original drawing has been carefully compared with the work As Constructed, as to line, level and dimensions and it has been accurately amended so as to constitute a true and correct record of the work As Constructed.

CARDNO (QLD) PTY LTD  
 WORK AS EXECUTED  
 SUPERVISED: DRAWN: CHECKED:  
 PASSED:  
 DATE: 09/01/2007 RPER: 7109 *[Signature]*

DRAWING REVISIONS		REFERENCE DRAWINGS		DESIGN FILE No.	M1681	DESIGNED	CARDNO	THIS WORK WAS PREPARED BY:			JOB TITLE		CSC SUBMISSION REFERENCE	
REV.	REVISION DESCRIPTION	DRG. No.	DESCRIPTION	CONSTRUCT. No.	M1681	DATE	09/02/07	Consulting Engineers			TRINITY WATERS ESTATE BEACHMERE STAGE 2A PEET AND COMPANY LIMITED		IMP-7	
A	ORIGINAL ISSUE TO COUNCIL			SURVEY FILE No.	M1681	DRAWN	20/03/09	JF&P CONSULTING ENGINEERS PTY. LTD. ABN 77 050 414 038 237-239 Bradman Avenue, Maroochydore, Queensland, 4558 telephone (07) 5433 2500			'AS CONSTRUCTED SEWER'		No. OF PLANS	REV.
				FIELD BOOK		DATE	20/03/09	SCALE 1:500 ORIGINAL SIZE A1			38006			A
				LOG BOOK		CHECKED	ADF				ASCON GRID NUMBER			
				LEVEL DATUM	AHD RL2.249	DATE	20/03/09				38006			
				DATUM	PSM 90413						38006			



**"WORKS AS CONSTRUCTED"**  
 It is certified that the original drawing has been carefully compared with the work As Constructed, as to line, level and dimensions and it has been accurately amended so as to constitute a true and correct record of the work As Constructed.

CARDNO (QLD) PTY LTD  
 WORK AS EXECUTED  
 SUPERVISED: DRAWN: CHECKED:  
 PASSED: DATE: 06/04/09 RPEQ: 7169 *[Signature]*

169983  
 HCH 000  
 OFFSET 1.35  
 JVP UB  
 SL 2.503  
 IL -1.095  
 SD SIDE 1.428  
 SD OTHER 3.500  
 UUL -1.298  
 UUL -1.429  
 UUL -1.458  
 UUL -1.519  
 UPVC 0150  
 30.628  
 Type 1 UPVC  
 SNB (SEH) 7.758  
 Type 1  
 SNB (SEH)  
 1/1/1 SL 2.200  
 2.00  
 2.5  
 2.35

DRAWING REVISIONS		REFERENCE DRAWINGS		DESIGN FILE No.	M1681	DESIGNED	CARDNO	THIS WORK WAS PREPARED BY:			JOB TITLE		CSC SUBDIVISION REFERENCE	
REV.	REVISION DESCRIPTION	DRG. No.	DESCRIPTION	CONSTRUCT. No.	M1681	DATE	09/02/07	Consulting Engineers			TRINITY WATERS ESTATE		IMP-7	
A	ORIGINAL ISSUE TO COUNCIL			SURVEY FILE No.	M1681	DRAWN	PEP	JF&P CONSULTING ENGINEERS PTY. LTD. ABN 77 050 414 036 237-239 Bradman Avenue, Microchydote, Queensland, 4558 Telephone (07) 5433 2900			BEACHMERE STAGE 2A		No. OF PLANS	
				FIELD BOOK		DATE	20/03/09	SCALE 1:500 ORIGINAL SIZE A1			PEET AND COMPANY LIMITED		ASCON GRID NUMBER REV.	
				LOG BOOK		CHECKED	ADF				Telephone: (07) 5433 0100		38007	
				LEVEL DATUM	AHD RL2.249	DATE	20/03/09	Fax: (07) 5433 4000		'AS CONSTRUCTED SEWER'				
				DATUM	PSM 90413									

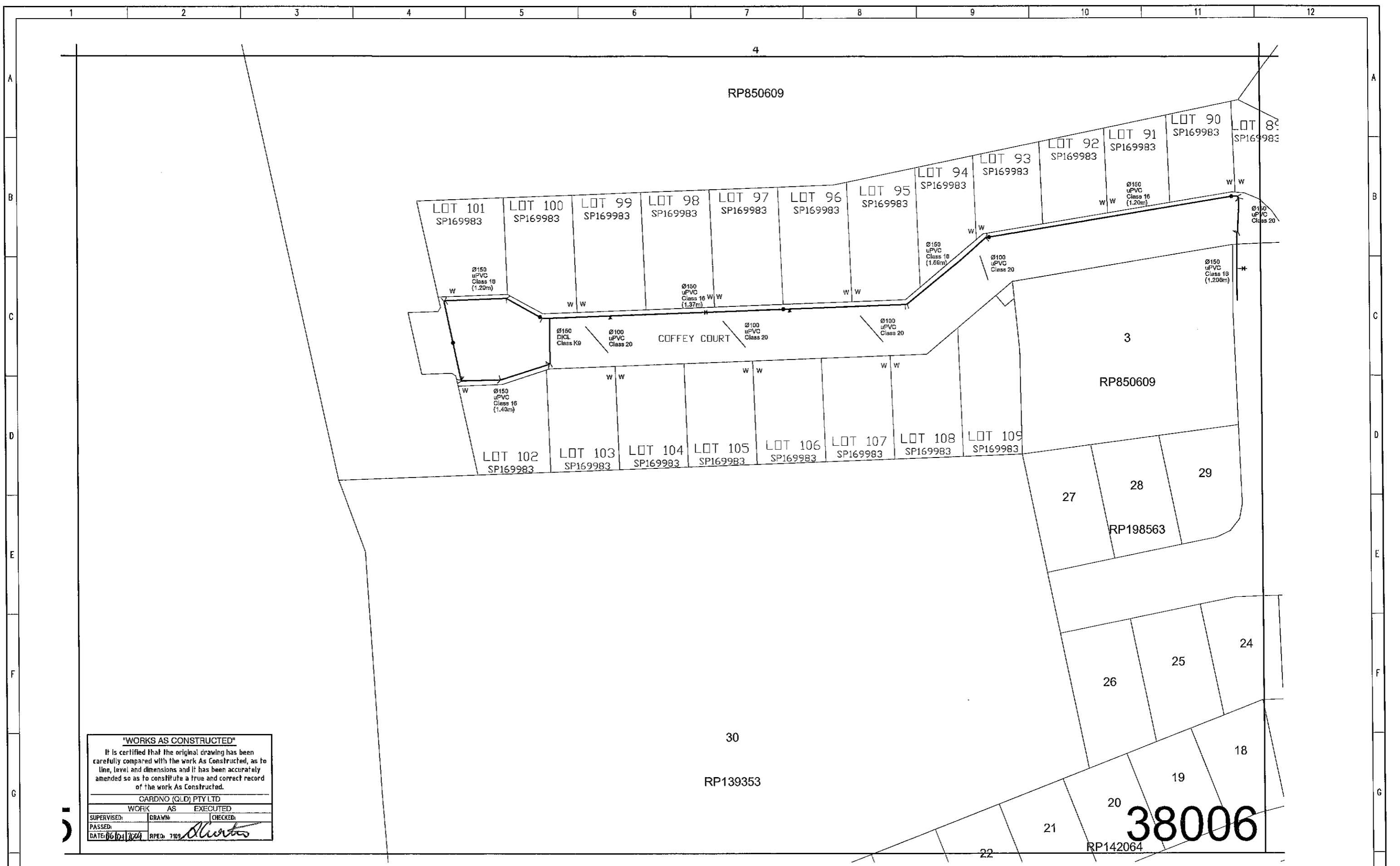

**"WORKS AS CONSTRUCTED"**  
 It is certified that the original drawing has been carefully compared with the work As Constructed, as to line, level and dimensions and it has been accurately amended so as to constitute a true and correct record of the work As Constructed.

CARDNO (QLD) PTY LTD  
 WORK AS EXECUTED  
 SUPERVISED: WORK AS EXECUTED  
 DRAWN: CHECKED:  
 PASSED:  
 DATE: 06/04/2009 RPE: 7109 *[Signature]*

DRAWING REVISIONS		REFERENCE DRAWINGS		DESIGN FILE No.	M1681	DESIGNED	CARDNO	THIS WORK WAS PREPARED BY:		MORETON BAY REGIONAL COUNCIL		JOB TITLE		CSC SUBMISSION REFERENCE	
REV.	REVISION DESCRIPTION	DRG. No.	DESCRIPTION	CONSTRUCT. No.	M1681	DATE	09/02/07	Consulting Engineers		CABOOLTURE DISTRICT OFFICE		TRINITY WATERS ESTATE		IMP-7	
A	ORIGINAL ISSUE TO COUNCIL			SURVEY FILE No.	M1681	DRAWN	PEP	JF&P CONSULTING ENGINEERS PTY. LTD. ABN 77 050 414 030		2 BASKING STREET CABOOLTURE QLD 4510		BEACHMERE STAGE 2A		No. OF PLANS	
				FIELD BOOK		DATE	20/03/09	237-239 Bradman Avenue,		PO BOX 159 CABOOLTURE QLD 4510		PEET AND COMPANY LIMITED		ASCON GRID NUMBER	
				LOG BOOK		CHECKED	ADF	Maroochydore, Queensland. 4556 telephone (07) 5443 2500		Telephone: (07) 5433 0100				REV.	
				LEVEL DATUM	AHD RL2.249	DATE	20/03/09	SCALE 1:500		ORIGINAL SIZE A1		'AS CONSTRUCTED WATER'		38006 A	
				DATUM	PSM 90413										



**"WORKS AS CONSTRUCTED"**  
 It is certified that the original drawing has been carefully compared with the work As Constructed, as to line, level and dimensions and it has been accurately amended so as to constitute a true and correct record of the work As Constructed.

CARDNO (QLD) PTY LTD  
 WORK AS EXECUTED  
 SUPERVISED: DRAWN: CHECKED:  
 PASSED: DATE: 16/04/2009 RPEQ: 7109 *[Signature]*

DT 89  
 169983

1:100  
 UP/PC  
 Class 20

DRAWING REVISIONS		REFERENCE DRAWINGS		DESIGN FILE No.	M1681	DESIGNED	CARDNO	THIS WORK WAS PREPARED BY:			JOB TITLE		CSC SUBDIVISION REFERENCE	
REV.	REVISION DESCRIPTION	DRG. No.	DESCRIPTION	CONSTRUCT. No.	M1681	DATE	09/02/07	Consulting Engineers			TRINITY WATERS ESTATE		IMP-7	
A	ORIGINAL ISSUE TO COUNCIL			SURVEY FILE No.	M1681	DRAWN	PEP	JF&P CONSULTING ENGINEERS PTY. LTD. ABN 77 050 414 038 237-238 Bradman Avenue, Maroochydore, Queensland, 4558 Telephone: (07) 5443 2500			BEACHMERE STAGE 2A		No. OF PLANS	
				FIELD BOOK		DATE	20/03/09				PEET AND COMPANY LIMITED		ASCEN GRID NUMBER	
				LOG BOOK		CHECKED	ADF						REV.	
				LEVEL DATUM	AHD RL2.249	DATE	20/03/09				'AS CONSTRUCTED WATER'		38007	
				DATUM	PSM 90413			SCALE 1:500 ORIGINAL SIZE A1					A	